

# Dingle Partners



## 307/5 Sutherland Street MELBOURNE VIC

1 1

Located in a vibrant Melbourne laneway neighborhood charmed with cafes and eateries, this apartment provides the perfect base to enjoy everything Melbourne has to offer. Centrally positioned, only a block walk to Melbourne Central, Emporium, QV shopping, Hardware Lane and Queen Victoria market.

This contemporary apartment offers both comfort and functionality with its sleek open plan layout - ease of flow between the kitchen, living & dining area to a private balcony making it perfect for entertaining guests or simply relaxing. The apartment is offered fully furnished ready to move in or lease out for \$500 per week.

### Apartment Features:

- Open-Plan Kitchen, Dining and Living
- Stone Bench-tops throughout

**Price** : \$290,000 - \$315,000

**View** : <https://www.dinglepartners.com.au/sale/vic/inner-city/melbourne/residential/apartment/8096367>



**Charles Tran**  
0412278987

<https://www.dinglepartners.com.au>

Dingle Partners, Real Estate, Sales, Melbourne, Buy, Sell, Property Management, leasing, rent, Richmond, Carlton, St.Kilda Rd, CBD, Auction, agent, house, apartment, tenant, landlord, owner

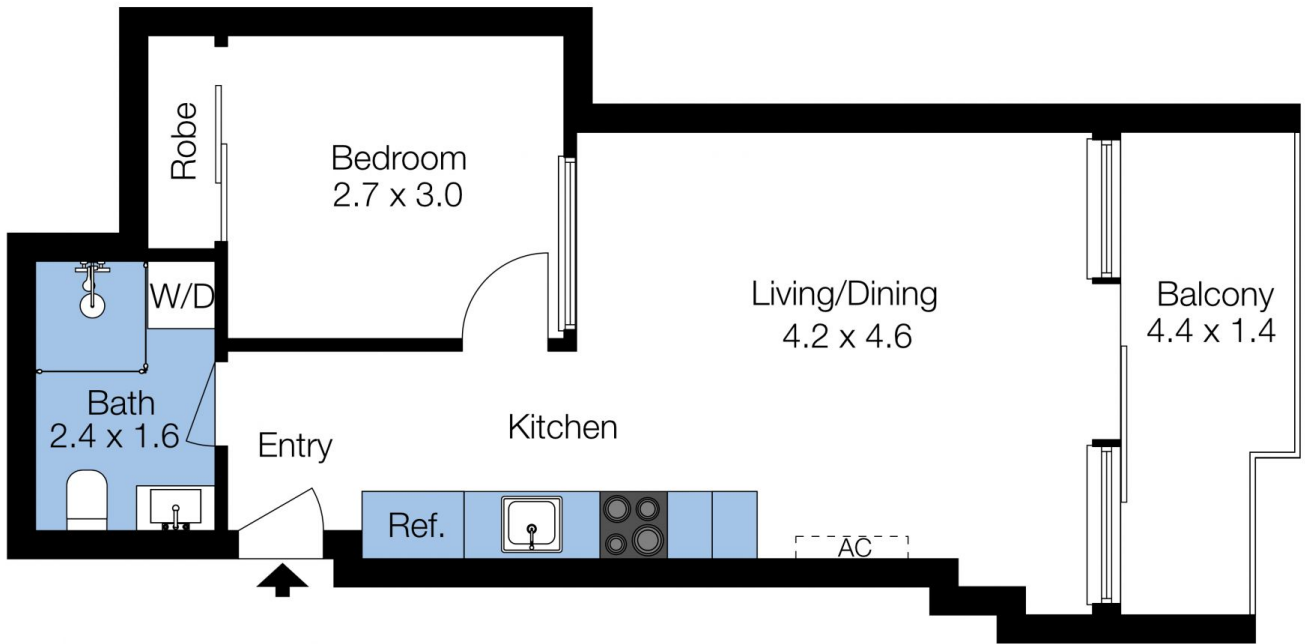
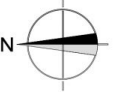

The floor plan is not to scale; measurements are indicative and in metres. Exterior elements are not in position. Plans should not be relied on. Interested parties should make and rely on their own enquiries.

Produced by **DIAKRIT**