

Dingle Partners



106/557 Little Lonsdale Street MELBOURNE VIC

2  1 

Featuring a huge private terrace to enjoy and so well positioned for city living or investment, this two bedroom Metro Park West tower apartment is perfectly situated between King and William Streets, with the legal district, Flagstaff Station & Gardens, trams, Q V Market and so much the city has to offer right at your fingertips.

The accommodation comprises entry through to the open plan living with floor to ceiling windows, and direct access to the huge private terrace, heating & cooling and a well appointed kitchen area, that includes electric cooking, dishwasher, rangehood and good cupboard space. Both bedrooms are double sized and have mirrored built in robes. Additional features include the central bathroom, Euro Style laundry and secure intercom entry. An ideal opportunity for the owner occupier to move in and enjoy or the investor seeking an affordable entry into the high

Price : UNDER OFFER

View : <https://www.dinglepartners.com.au/sale/vic/inner-city/melbourne/residential/apartment/8122731>



Robert Eggers
0412329340

<https://www.dinglepartners.com.au>

Dingle Partners, Real Estate, Sales, Melbourne, Buy, Sell, Property Management, leasing, rent, Richmond, Carlton, St.Kilda Rd, CBD, Auction, agent, house, apartment, tenant, landlord, owner

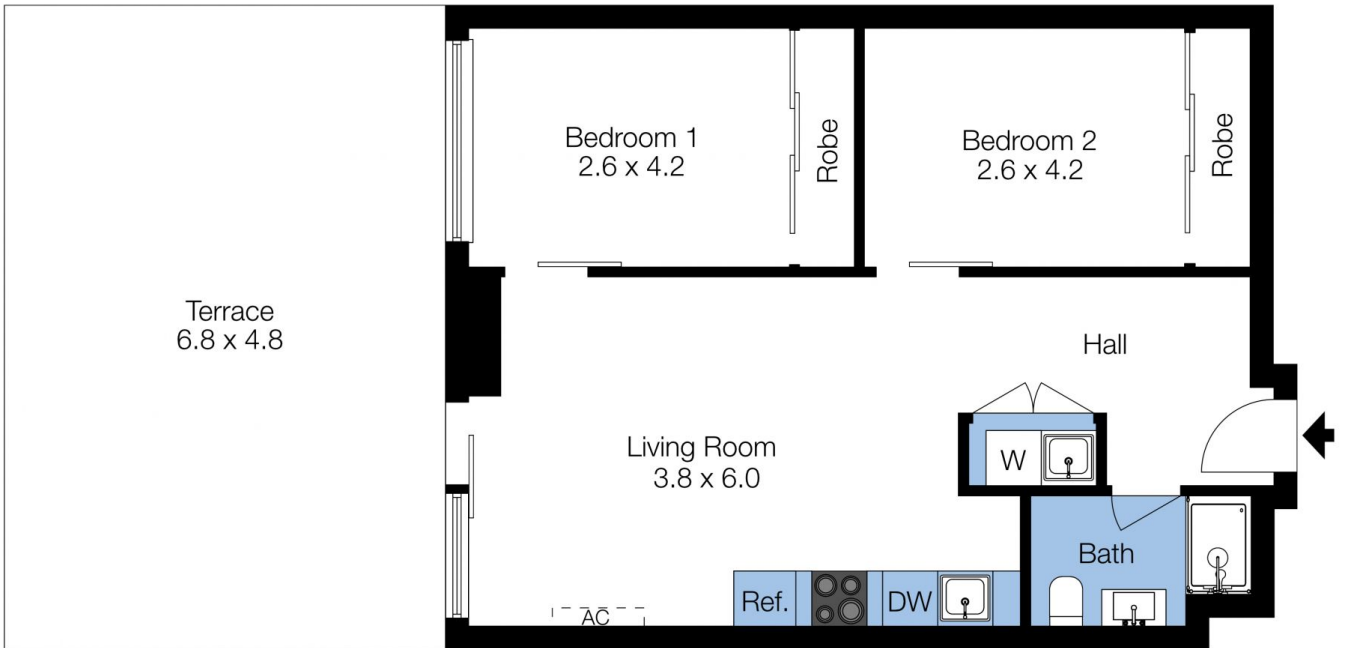

The floor plan is not to scale; measurements are indicative and in metres. Exterior elements are not in position. Plans should not be relied on. Interested parties should make and rely on their own enquiries.

Produced by DIAKRIT